

(FC) Flute Cover

Fire Stop Flute Cover profiles

Corrugated strap for horizontal use to span fluted areas of unprotected or protected metal decks in up to 2 hr rated assemblies. Profile attached to deck "valley" surfaces a max 16" o.c. on both sides. Profiles provide a surface area for attachment of head of wall partition track profiles centered or offset underneath and parallel to deck fluted areas per listed assemblies in UL Fire Resistance Directory.

Product Data & Ordering Information:

Material:

Yield Strength: Grade 33ksi
Coating: CP60 (G90 available)

33mils: 20 Gauge, 0.0346" Design Thickness, 0.0329" Min. Thickness

Dimensions:

Widths (W): 675 (6-3/4") and 700 (7")
Length: 10'-0"

ASTM & Code Standards:

- ASTM A1003, C645 & C955
- UL2079, E1966, E119
- SDS & Product Certification Information is available at www.clarkdietrich.com/SupportDocs.

09.22.16 (Non-Structural Metal Framing)

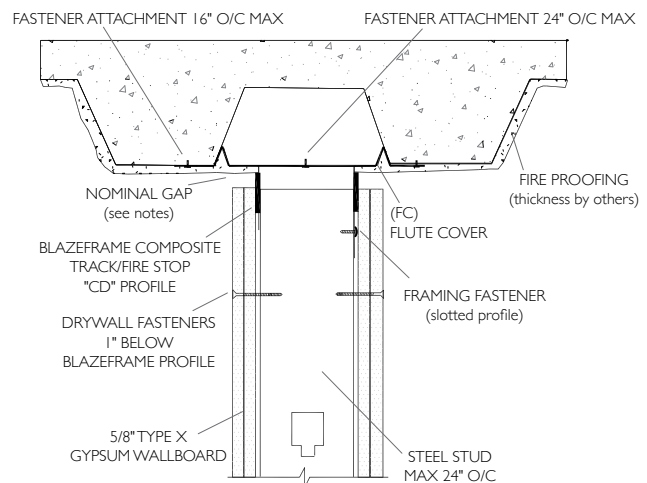
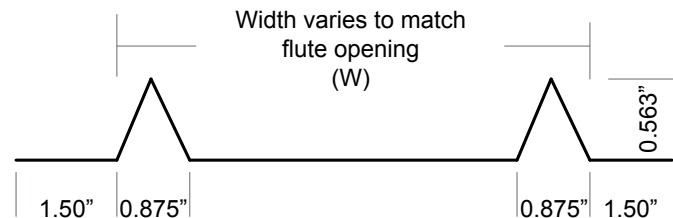
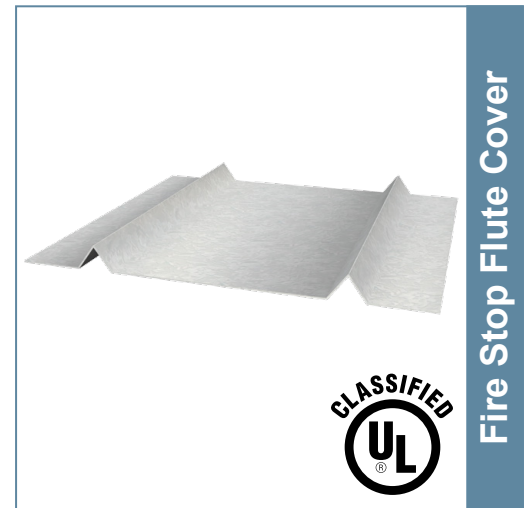

Sustainability Credits:

For more details and LEED letters contact Technical Services at 888-437-3244 or visit www.clarkdietrich.com/LEED

LEED v4 MR Credit -- Building Product Disclosure and Optimization: EPD (1 point) - Sourcing of Raw Materials (1 point) - Material Ingredients (1 point) - Construction and Demolition Waste Management (up to 2 points) - Innovation Credit (up to 2 points).

LEED 2009 Credit MR 2 & MR 4 -- ClarkDietrich's steel products are 100% recyclable and have a minimum recycled content of 34.2% (19.8% post-consumer and 14.4% pre-consumer). If seeking a higher number to meet Credit MR 5, please contact us at (info@clarkdietrich.com / 888-437-3244)

CD-FC © 12/1/17 ClarkDietrich Building Systems

Project Information

Name:
Address:

Contractor Information

Name:
Contact:
Phone:
Fax:

Architect Information

Name:
Contact:
Phone:
Fax: