

## BlazeFrame® Flute Cover (FC)

### "FC" Fire Stop Flute Cover profiles

Corrugated strap for horizontal use to span fluted areas of unprotected or protected metal decks in up to 2 hr rated assemblies. Profile attached to deck "valley" surfaces a max 16" o.c. on both sides.

Profiles provide a surface area for attachment of head of wall partition track profiles centered or offset underneath and parallel to deck fluted areas per listed assemblies in UL Fire Resistance Directory.

#### Product Data & Ordering Information:

Material: Yield Strength: Grade 33ksi  
 Coating: CP60 (G90 available)  
 33mils: 20ga, 0.0346" Design Thickness, 0.0329" Min. Thickness

#### Dimensions:

Width: 425 (4-1/4"), 675 (6-3/4") and 725 (7-1/4")  
 Lengths: 10'

For connection details and fire rated assembly details on either of these systems, refer to [www.clarkdietrich.com/BlazeFrame](http://www.clarkdietrich.com/BlazeFrame).

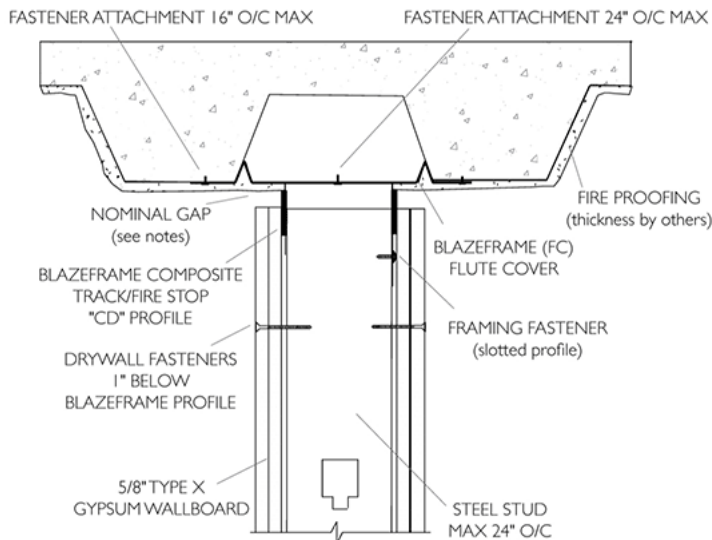

#### 09.22.16 (Non-Structural Metal Framing)

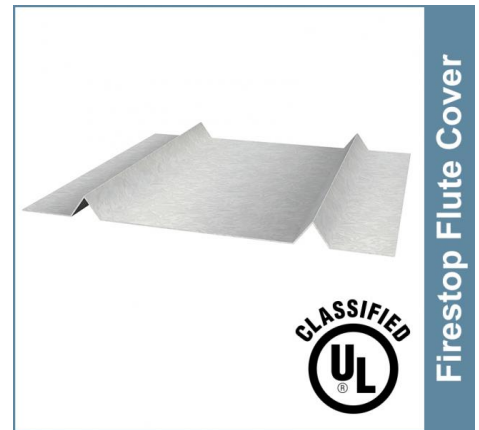

Firestop Flute Cover

- UL Classified and Listed Joint Systems
- Patents: [www.cd-patents.com](http://www.cd-patents.com)

#### ASTM & Code Standards:

- ASTM C645, C955, A1003 and A653
- UL 2079 - Fifth Edition compliant (When used in conjunction with BlazeFrame Perimeter L-Bead)
- IBC requires fire-resistant joint systems be tested in accordance w/the requirements of either ASTM E1966 or UL 2079.
- SDS & Product Certification Info available at [www.clarkdietrich.com/SupportDocs](http://www.clarkdietrich.com/SupportDocs)

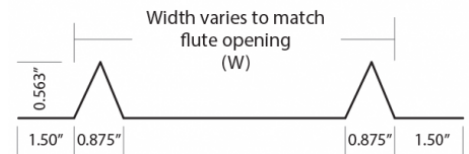

#### Project Information

Name:  
 Address:

#### Contractor Information

Name:  
 Contact:  
 Phone:  
 Fax:

#### Architect Information

Name:  
 Contact:  
 Phone:  
 Fax: