

## Pony Wall Heavy 24" (PW24)

### Partial wall framing connection to floor

ClarkDietrich Pony Wall Heavy is intended to support out-of-plane loading of cantilevered partial wall systems that are unsupported at the top track. Out-of-plane loads are transferred to the floor system through the base-plate, which is welded to the Pony Wall Heavy stud member.

For allowable loads and multiple connection options, reference [www.clarkdietrich.com/ponywall](http://www.clarkdietrich.com/ponywall) for more information.

#### Product Data & Ordering Information:

Plate Material:	ASTM A36 1/2" thick hot rolled steel
Stud Material:	Structural Grade 50 Type H (ST50H), 50ksi (340 MPa) 12ga (97mil), 0.1017" Design thickness, 0.0966" Min. thickness
Plate Dimensions:	3-3/8" x 8" x 1/2" thick (92.1mm x 203.2mm x 12.7mm)
Stud Dimensions:	3-5/8" x 2-1/2" x 23-1/4" tall (92.1mm x 63.5mm x 590.6mm)
Packaging:	Individually
Product weight:	10.0 lb/piece

#### ASTM & Code Standards:

- Sheet steel meets or exceeds requirements of ASTM A1003
- SDS & Product Certification Information available at [www.clarkdietrich.com/SupportDocs](http://www.clarkdietrich.com/SupportDocs)

### 05.40.00 (Cold-Formed Metal Framing)



Foundation Connections

- Anchors wall to floor with 1/2" anchors

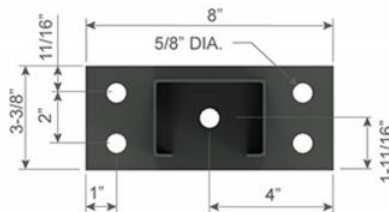
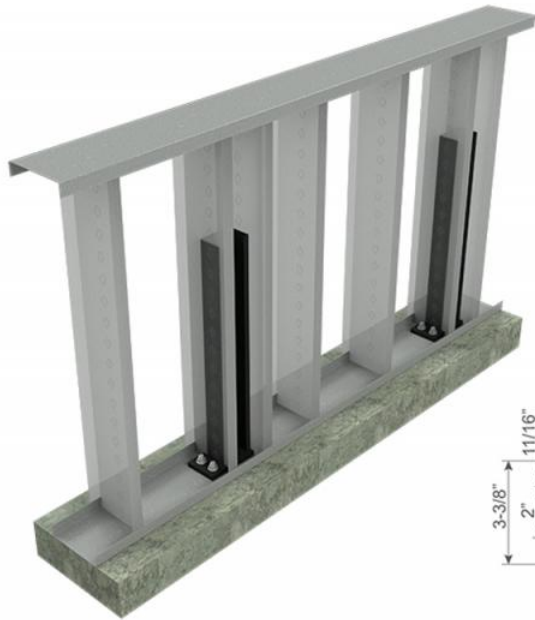

#### Sustainability Credits:

For more details and LEED letters contact Technical Services at 888-437-3244 or visit [www.clarkdietrich.com/LEED](http://www.clarkdietrich.com/LEED)

**LEED v4 MR Credit** -- Building Product Disclosure and Optimization: EPD (1 point) - Sourcing of Raw Materials (1 point) - Material Ingredients (1 point) - Construction and Demolition Waste Management (up to 2 points) - Innovation Credit (up to 2 points).

**LEED 2009 Credit MR 2 & MR 4** -- ClarkDietrich's steel products are 100% recyclable and have a national average recycled content of 34.2% (19.8% post-consumer and 14.4% pre-consumer). If seeking a higher number to meet Credit MR 5, please contact us at ([info@clarkdietrich.com](mailto:info@clarkdietrich.com) / 888-437-3244)

#### Project Information

Name:  
Address:

#### Contractor Information

Name:  
Contact:  
Phone:  
Fax:

#### Architect Information

Name:  
Contact:  
Phone:  
Fax: