

## 093 Vinyl Control Joint Control Joint

093 Vinyl Control Joint is applied between abutting gypsum panels and is used to relieve stresses of expansion and contraction of drywall in large ceiling and wall expanses over 30'. Control joints are installed from door header to ceiling, from floor to ceiling in long partition runs and from wall to wall in large ceiling areas.

Plastic tape protects 1/4" opening x 7/16" deep reveal and is removed after compound is applied and finished. Where sound transmission is a consideration, an approved seal must be provided behind control joint. Use metal control joints wherever fire ratings are a concern.

### Product Data & Ordering Information:

Material: 0.028" PVC (Polyvinyl Chloride)  
 Dimensions: 1/4" opening x 7/16" deep reveal

Product code	Board thickness	Reveal width	Overall width	Length	Pcs./Ctn.
CJV16-10	1/2" or 5/8"	3/16"	2-1/4"	10'	20

### ASTM & Code Standards:

- ASTM C1047 - Standard Specification for Accessories for Gypsum Wallboard and Gypsum Veneer Base
- ASTM D3678 Class 2 materials
- Installation: ASTM C840 & C841 (Interior Finishes)
- SDS & Product Certification Information is available at [www.clarkdietrich.com/SupportDocs](http://www.clarkdietrich.com/SupportDocs)

### Storage:

All stored materials shall be kept dry. Materials shall be stacked off the ground, supported on a level platform, and protected from the weather.

## 09.22.00 (Support for Plaster & Gypsum Board)



- Use with drywall or veneer plaster
- Moisture resistant and rust proof
- Maintains profile after cutting
- Perforations enhance compound adhesion

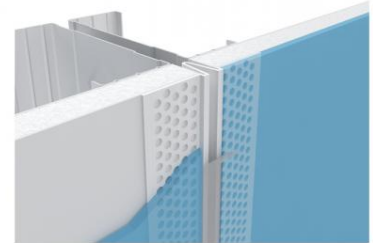

### Project Information

Name:  
Address:

### Contractor Information

Name:  
Contact:  
Phone:  
Fax:

### Architect Information

Name:  
Contact:  
Phone:  
Fax: