

## Pre-Installed Channel Reveal

### Create clear surface channels in exterior wall and ceiling systems

Designed to be applied prior to the installation of a rigid substrate where a reveal is required. Perforated flanges allow the base coat mixture to easily flow through and bond with the substrate. Always use backing or blocking material behind surface mounted reveal. Caulk all intersections, butt joints, ends, and corners at the time of installation. Not to be used in lieu of control joints or expansion joints. Factory fabricated intersections are also available for all ClarkDietrich channel reveals.

### Product Data & Ordering Information:

Product Code	Finish Thickness	Min Board Thickness	Reveal Width	Perforated Flanges	PCS/Box
DR50-50	1/16" - 3/32"	1/2"	1/2"	1-1/8"	25
DR50-75	1/16" - 3/32"	1/2"	3/4"	1-1/8"	25
DR50-100	1/16" - 3/32"	1/2"	1"	1-1/8"	20
DR50-150	1/16" - 3/32"	1/2"	1-1/2"	1-1/8"	20
DR50-200	1/16" - 3/32"	1/2"	2"	1-1/8"	14
DR50-250	1/16" - 3/32"	1/2"	2-1/2"	1-1/8"	14
DR50-300	1/16" - 3/32"	1/2"	3"	1-1/8"	12

### Code Approvals & Performance Standards

- [ASTM D1784](#) Standard Classification System and Basis for Specification for Rigid Poly(Vinyl Chloride) (PVC) Compounds and Chlorinated Poly(Vinyl Chloride) (CPVC) Compounds
- [ASTM D4216](#) Standard Specification for Rigid Poly(Vinyl Chloride) (PVC) and Related PVC and Chlorinated Poly(Vinyl Chloride) (CPVC) Building Products Compounds
- [ASTM E2110](#) Standard Terminology for Exterior Insulation and Finish Systems (EIFS)
- [ASTM E2273](#) Standard Test Method for Determining the Drainage Efficiency of Exterior Insulation and Finish Systems (EIFS) Clad Wall Assemblies
- [ASTM E2486](#) Standard Test Method for Impact Resistance of Class PB and PI Exterior Insulation and Finish Systems (EIFS)
- [ASTM E2511](#) Standard Guide for Detailing of EIFS-Clad Barrier and Drainage Wall Assemblies
- [ASTM E2568](#) Standard Specification for PB Exterior Insulation and Finish Systems
- [SDS Vinyl Corp](#) PVC Compounds

### Storage

All stored materials shall be kept dry. Materials shall be stacked off the ground, supported on a level platform, and protected from the weather.

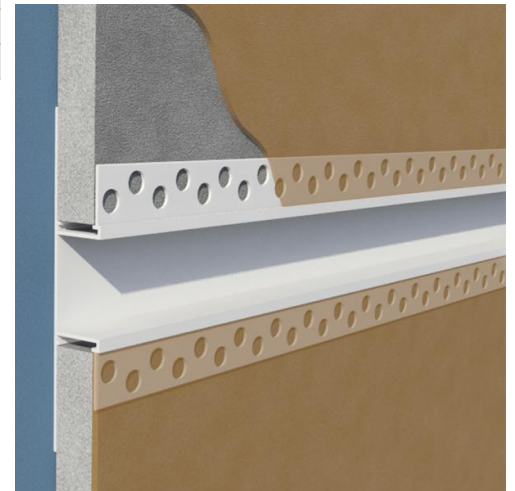
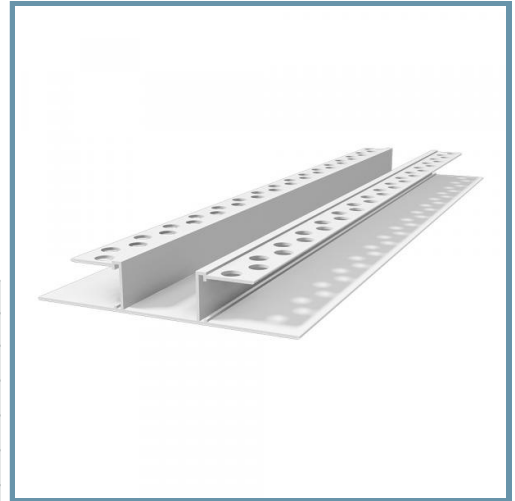

- Available for board thicknesses of 1/2" and 5/8"