

Control Joint and Reveal Combinations

Designed to relieve stress and assist in controlling cracking in large areas of walls and ceilings

Controls cracking and relieves stress while creating a 1/4" to 1-1/2" reveal in Stucco. Surface connector clips are provided for alignment and as a base for sealants.

Control Joints help with the embedment of the lath and flange while assisting with tying requirements of discontinuous lath to the joint.

Product Data & Ordering Information:

Product code	Ground	Overall Width	Reveal	Pcs./Box
1538R-150	3/8"	5-1/2"	1-1/2"	18
1550R-150	1/2"	5-1/2"	1-1/2"	18
1558R-150	5/8"	5-1/2"	1-1/2"	15
1575R-150	3/4"	5-1/2"	1-1/2"	15
1578R-150	7/8"	5-1/2"	1-1/2"	14
15100R-150	1"	5-1/2"	1-1/2"	14

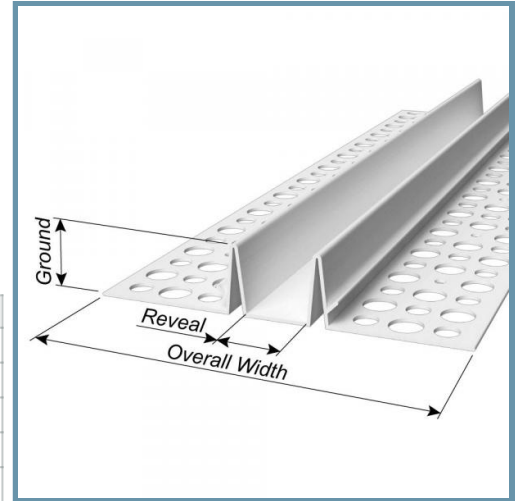

Made in white or these standard thru-body colors:

Tan Brown Gray Black

Contact ClarkDietrich for pricing and availability

Code Approvals & Performance Standards

- [ASTM C1063](#) Standard Specification for Installation of Lathing and Furring to Receive Interior and Exterior Portland Cement-Based Plaster
- [ASTM C1861](#) Standard Specification for Lathing and Furring Accessories, and Fasteners, for Interior and Exterior Portland Cement-Based Plaster
- [ASTM D1784](#) Standard Classification System and Basis for Specification for Rigid Poly(Vinyl Chloride) (PVC) Compounds and Chlorinated Poly(Vinyl Chloride) (CPVC) Compounds
- [ASTM D4216](#) Standard Specification for Rigid Poly(Vinyl Chloride) (PVC) and Related PVC and Chlorinated Poly(Vinyl Chloride) (CPVC) Building Products Compounds
- [SDS Vinyl Corp](#) PVC Compounds

Storage

All stored materials shall be kept dry. Materials shall be stacked off the ground, supported on a level platform, and protected from the weather.

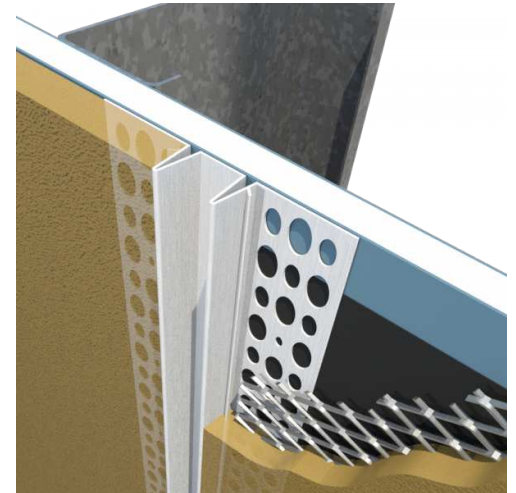

- Available in 1/4", 1/2" and 3/4" reveal widths