

BackerBead® with Rip-Bead®

Casing Bead with factory applied Blue Backer Rod to assure proper sealant

1/4" removable leg provides a clean, stucco-free caulk gap. A clean 1/4" x 1/4" caulk gap assures the most efficient caulk seal for optimal moisture protection.

Factory-applied blue backer rod with preset width and depth to ensure proper caulk gap for sealant application. When the gap is properly caulked, the blue backer rod will no longer be visible. Easy to install in tight areas such as recessed doors and windows, providing added moisture protection and a clean finish. A labor saving and quality control product for use at exterior openings in wet wall stucco applications.

To properly assemble a wall cladding system using stucco or manufactured stone veneer, the best practice is to maintain a "gap" around door and window openings and install a backer rod with compatible sealant in order to keep moisture out. The use of BackerBead® ensures that the correct caulk gap will be created around all door and window openings on exterior walls. The gap is predetermined by the factory-applied, closed-cell backer rod that is properly aligned and adhered to the vinyl casing bead. This approach eliminates the need to install the backer rod separately, saving time and ensuring a consistent, normal gap width and depth of 1/4" x 1/4". When installed and caulked properly, BackerBead® provides added protection from water penetration.

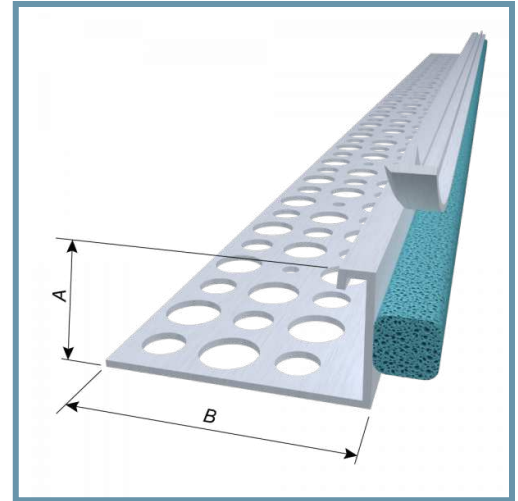

Product Data & Ordering Information:

Product code	Ground (A)	Flange (B)	Length	Pcs./Box
6658BBR	5/8"	1-3/4"	10'	50
6678BBR	7/8"	1-3/4"	10'	50

White backer rod optional (for clear sealant). Add -WH to product code, example 6658BBSF-WH.

Vinyl Colors available: Standard color White or Tan, Brown, Gray and Black. Call for pricing.

BackerBead also available with a solid flange upon request. Add U to product code, example: 6658BBSFU.

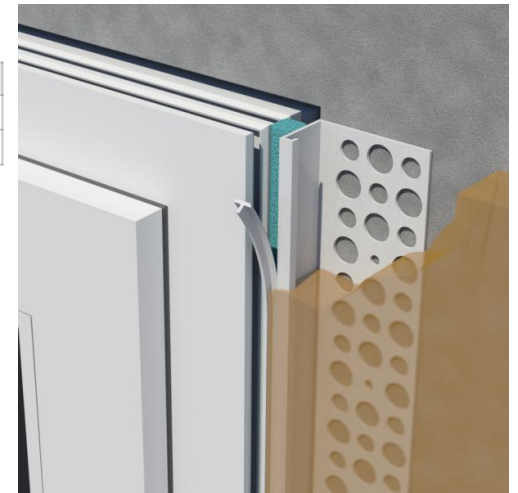

Code Approvals & Performance Standards

- [ASTM C1063](#) Standard Specification for Installation of Lathing and Furring to Receive Interior and Exterior Portland Cement-Based Plaster
- [ASTM C1330](#) Standard Specification for Cylindrical Sealant Backing for Use with Cold Liquid-Applied Sealants
- [ASTM C1780](#) Standard Practice for Installation Methods for Cement-based Adhered Masonry Veneer
- [ASTM C1861](#) Standard Specification for Lathing and Furring Accessories, and Fasteners, for Interior and Exterior Portland Cement-Based Plaster
- [ASTM D1784](#) Standard Classification System and Basis for Specification for Rigid Poly(Vinyl Chloride) (PVC) Compounds and Chlorinated Poly(Vinyl Chloride) (CPVC) Compounds
- [ASTM D4216](#) Standard Specification for Rigid Poly(Vinyl Chloride) (PVC) and Related PVC and Chlorinated Poly(Vinyl Chloride) (CPVC) Building Products Compounds
- [ASTM E331](#) Standard Test Method for Water Penetration of Exterior Windows, Skylights, Doors, and Curtain Walls by Uniform Static Air Pressure Difference
- [SDS Vinyl Corp](#) PVC Compounds

Storage

All stored materials shall be kept dry. Materials shall be stacked off the ground, supported on a level platform, and protected from the weather.

