

## (FC) Flute Cover

### Fire Stop Flute Cover profiles

Corrugated strap for horizontal use to span fluted areas of unprotected or protected metal decks in up to 2 hr rated assemblies. Profile attached to deck "valley" surfaces a max 16" o.c. on both sides. Profiles provide a surface area for attachment of head of wall partition track profiles centered or offset underneath and parallel to deck fluted areas per listed assemblies in UL Fire Resistance Directory.

#### Product Data & Ordering Information:

##### Material:

Yield Strength: Grade 33ksi  
Coating: CP60 (G90 available)

33mils: 20 Gauge, 0.0346" Design Thickness, 0.0329" Min. Thickness

##### Dimensions:

Widths (W): 675 (6-3/4") and 700 (7")  
Length: 10'-0"

#### ASTM & Code Standards:

- ASTM A1003, C645 & C955
- UL2079, E1966, E119
- SDS & Product Certification Information is available at [www.clarkdietrich.com/SupportDocs](http://www.clarkdietrich.com/SupportDocs).

#### 09.22.16 (Non-Structural Metal Framing)

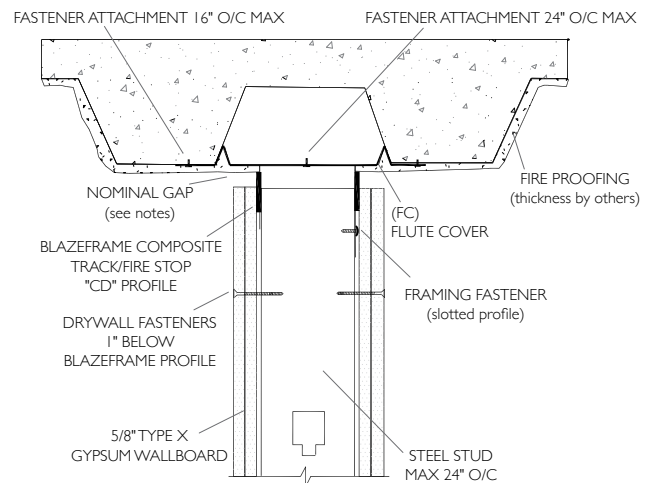
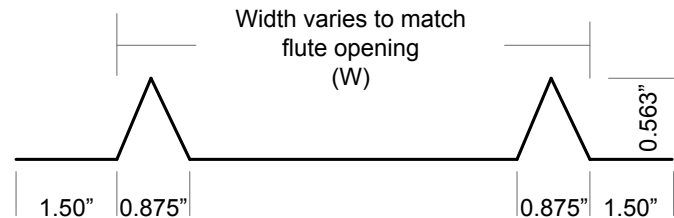
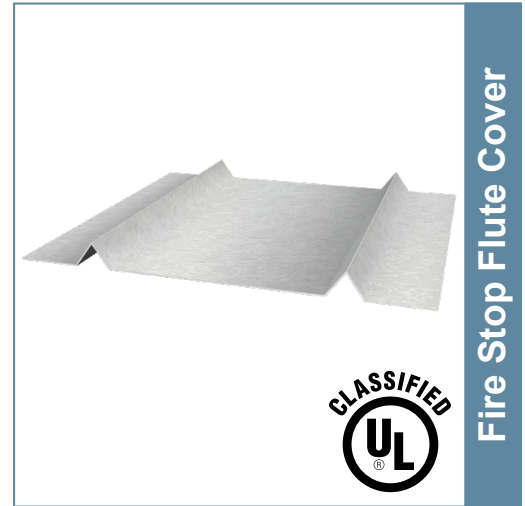

#### Sustainability Credits:

For more details and LEED letters contact Technical Services at 888-437-3244 or visit [www.clarkdietrich.com/LEED](http://www.clarkdietrich.com/LEED)

**LEED v4 MR Credit** -- Building Product Disclosure and Optimization: EPD (1 point) - Sourcing of Raw Materials (1 point) - Material Ingredients (1 point) - Construction and Demolition Waste Management (up to 2 points) - Innovation Credit (up to 2 points).

**LEED 2009 Credit MR 2 & MR 4** -- ClarkDietrich's steel products are 100% recyclable and have a national average recycled content of 34.2% (19.8% post-consumer and 14.4% pre-consumer). If seeking a higher number to meet Credit MR 5, please contact us at ([info@clarkdietrich.com](mailto:info@clarkdietrich.com) / 888-437-3244)

#### Project Information

Name:  
Address:

#### Contractor Information

Name:  
Contact:  
Phone:  
Fax:

#### Architect Information

Name:  
Contact:  
Phone:  
Fax: